

CLASSIC II GELATO/ICE CREAM ROUND TUBS SHOWCASE

STANDARD FEATURES

- Tilt back front glass opening
- Temperature front and side glass single pane with anti-fog serigraph
- Stainless steel insulated body with tubular painted galvanized chassis
- Diffused LED lighting 3000°K
- Plexiglass sliding back doors
- Stainless steel worktop
- Silver trim finish
- Dixell digital controller
- Air cooled condensing unit
- Cases ship standard unfinished front and stainless steel skin sides



Photo shown with optional RAL color finish. Standard cases are unfinished with stainless steel skin sides.

OPTIONS

- Champagne trim finish
- Stainless steel inserts and pans
- Dipper well
- Cone holder
- Frozen cake stainless steel trays
- Marble/granite worktop
- RAL color finish/wood laminate front and side panels
- Remote/water cooled unit
- Casters



Vist our website for more finishing options and RAL colors
www.oscartek.com

CLASSIC II GELATO/ICE CREAM - ROUND TUBS				
TECHNICAL FEATURES		MODELS		
		CLASSIC II GICRT1150 (CLCIIGL45RT)	CLASSIC II GICRT1650 (CLCIIGL65RT)	CLASSIC II GICRT2150 (CLCIIGL85RT)
External Dimensions (L-D-H)	Inches	*45 1/4" - 34 3/16" - 51"	*64 15/16" - 34 3/16" - 51"	*84 5/8" - 34 3/16" - 51"
	MM	*1150 - 869 - 1295	*1650 - 869 - 1295	*2150 - 869 - 1295
Crated Dimensions (L-D-H)	Inches	52" - 41" - 59"	70" - 41" - 59"	91" - 41" - 59"
	MM	1320 - 1041 - 1498	1778 - 1041 - 1498	2311 - 1041 - 1498
3 Gallon Round Tubs Capacity** 10" x 9 5/8" x 8 3/4" (254mm x 245mm x 222mm)	Number of Round Tubs	 8	 12	 16
Refrigeration	Type	Fan Ventilated	Fan Ventilated	Fan Ventilated
Operating Temperature	°F	-0.4°F	-0.4°F	-0.4°F
Compressor	Nr./Type	1 / Hermetic	1 / Hermetic	1 / Hermetic
Electric Supply	(V/Ph/Hz)	208-220/1/60	208-220/1/60	208-220/1/60
BTU'S @ -25°F				
Evap Temperature	BTU'S	1900	2600	3100
Power Consumption	(W/A)	1700/9.1	2200/11.5	2700/14.8
Defrost	Mode/Type	Hot Gas	Hot Gas	Hot Gas
Climatic Class	°F/H.R.	75°F-55%RH	75°F-55%RH	75°F-55%RH
Refrigerant Gas	Type	R404A / R452A	R404A / R452A	R404A / R452A
Net Weights	Lb	375	530	605
Crated Weights	Lb	583	748	924

* DIMENSIONS ARE WITHOUT SIDE PANELS

**ROUND TUBS NOT INCLUDED

*Factory in its effort to upgrade and improve our products, has the right to change, modify, discontinue or change any feature, size or capacity on any model without prior notice.



512 South Airport Blvd., South San Francisco, CA 94080
Tel: 855.885.2400 | 650.342.2400 | Fax: 650.342.7400
sales@oscartek.com | www.oscartek.com



CLASSIC II GELATO/ICE CREAM ROUND TUBS SHOWCASE

SECTION VIEW

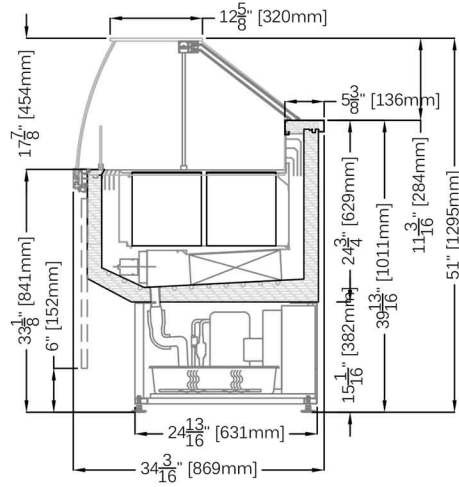

PLAN VIEWS: CLASSIC II GICRT1150, CLASSIC II GICRT1650, CLASSIC II GICRT2150

ELECTRICAL LEGEND	
∞	REFRIGERATED LINES
⌀	DRAIN
⚡	POWER

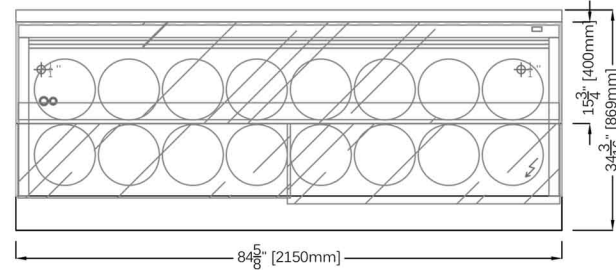
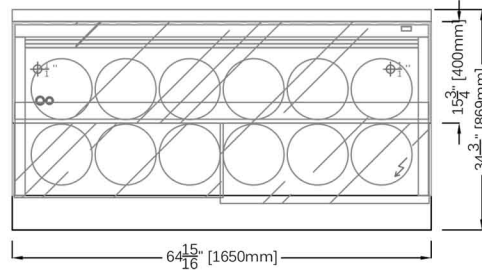
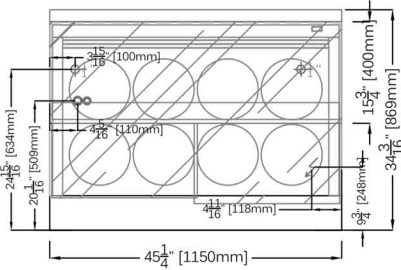

REAR ELEVATIONS (OPERATOR SIDE): CLASSIC II GICRT1150, CLASSIC II GICRT1650, CLASSIC II GICRT2150

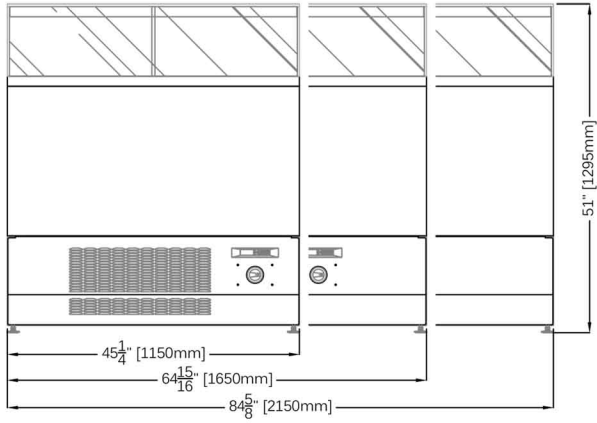

*Factory in its effort to upgrade and improve our products, has the right to change, modify, discontinue or change any feature, size or capacity on any model without prior notice.



512 South Airport Blvd., South San Francisco, CA 94080
 Tel: 855.885.2400 | 650.342.2400 | Fax: 650.342.7400
 sales@oscartek.com | www.oscartek.com

