

CLASSIC SQUARE

Gelato Showcase

STANDARD FEATURES

- Stainless steel insulated body with tubular painted galvanized chassis
- Dixell digital controller
- Air cooled condensing unit
- Temperature front and side glass single pane with anti-fog serigraph
- Tilt back front glass
- LED lighting
- Plexiglass sliding doors
- Stainless steel work bench
- Cases ship standard unfinished front and stainless steel skin sides



OPTIONS

- Stainless steel inserts and pans
- Dipper well
- Cone holder
- Frozen cake stainless steel trays
- Dual temperature zone
- Marble/granite work counter
- RAL color finish/wood laminate
- Roll down curtain
- Remote/water cooled unit
- Matching front cabinetry counters with top glass
- Casters



CLASSIC SQUARE GELATO					
TECHNICAL FEATURES		MODELS			
		CLASSIC SG1000	CLASSIC SG1500	CLASSIC SG2000	CLASSIC SG2000 DUAL TEMP
External Dimensions (L-D-H)	Inches	*39 3/8" - 38 1/16" - 52 3/8"	*59 1/16" - 38 1/16" - 52 3/8"	*78 3/4" - 38 1/16" - 52 3/8"	*78 3/4" - 38 1/16" - 52 3/8"
	Inches-MM	*1000 - 967 - 1330	*1500 - 967 - 1330	*2000 - 967 - 1330	*2000 - 967 - 1330
Crated Dimensions (L-D-H)	Inches	44" - 44" - 58"	65" - 44" - 58"	84 3/4" - 44" - 58"	84 3/4" - 44" - 58"
	Inches-MM	1100 - 1100 - 1473	1600 - 1100 - 1473	2100 - 1100 - 1473	2100 - 1100 - 1473
4 Liter Pan Capacity** 10 1/8" x 6 1/8" x 5 7/8" (258mm x 156mm x 150mm)	Pan Configuration				
5 Liter Pan Capacity** 14 3/16" x 6 1/2" x 4 3/4" (360mm x 165mm x 120mm)	Pan Configuration				
Refrigeration	Type	Fan Ventilated	Fan Ventilated	Fan Ventilated	Fan Ventilated
Operating Temperature	°C / °F	-18°C / -0.4°F	-18°C / -0.4°F	-18°C / -0.4°F	(2) -18°C / -0.4°F
Compressor	Nr./Type	1 / Hermetic	1 / Hermetic	1 / Hermetic	2 / Hermetic
BTU'S @ -25°F Evap Temperature	BTU'S	2450 BTU'S	3580 BTU'S	4550 BTU'S	1984 BTU'S
Electric Supply	(V/Ph/Hz)	400/3/50 (EU) 208-220/1/60 (USA)	400/3/50 (EU) 208-220/1/60 (USA)	400/3/50 (EU) 208-220/1/60 (USA)	400/3/50 (EU) 208-220/1/60 (USA)
Power Consumption	(W/A)	1950W / 5A	3200W / 6A	3800W / 9A	5000W / 12A
Defrost	Mode/Type	Reverse Cycle	Reverse Cycle	Reverse Cycle	Reverse Cycle
Climatic Class	R.	4/30/86/55%	4/30/86/55%	4/30/86/55%	4/30/86/55%
Refrigerant Gas	Type	R452A	R452A	R452A	R452A
Net Weights	Kg/Lb	190Kgs / 418Lbs	230Kgs / 507Lbs	270Kgs / 595Lbs	300Kgs / 661Lbs
Crated Weights	Kg/Lb	290Kgs / 639Lbs	360Kgs / 793Lbs	425Kgs / 936Lbs	455Kgs / 1003Lbs

* DIMENSIONS ARE WITHOUT SIDE PANELS

** PANS NOT INCLUDED

* Manufacturer reserves the right to change specifications without notice. Not responsible for error and omissions.



361-367 Beach Road, Burlingame, CA 94010
Tel: 855.885.2400 | 650.342.2400 | Fax: 650.342.7400
sales@oscartek.com | www.oscartek.com



CLASSIC SQUARE

Gelato Showcase

STANDARD - 4 LITER PANS

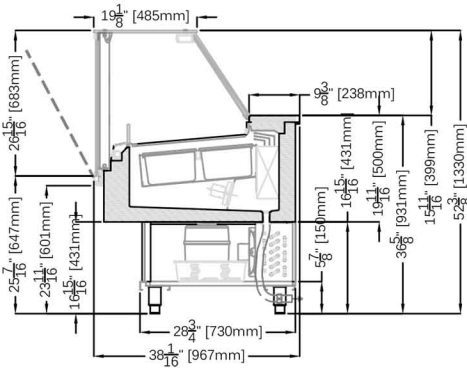

STANDARD - 5 LITER PANS

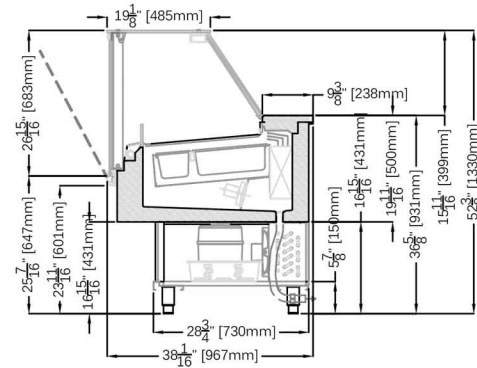

OPTIONAL: 45 1/4\"/>

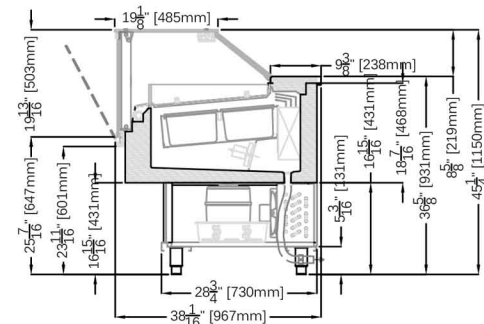

PLAN VIEWS - 4 LITER PANS:

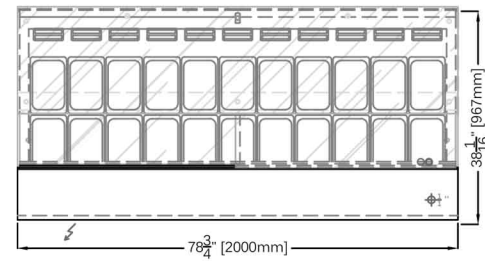
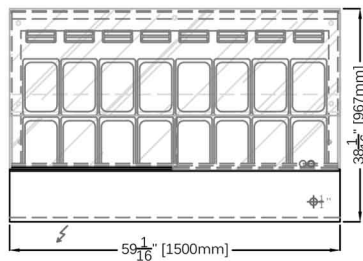
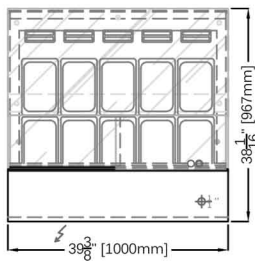

PLAN VIEWS - 5 LITER PANS:

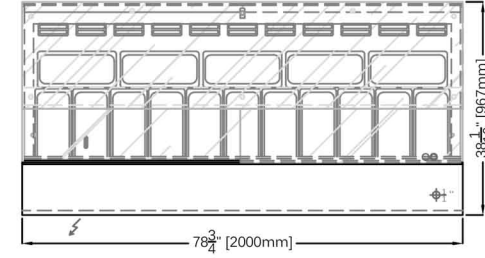
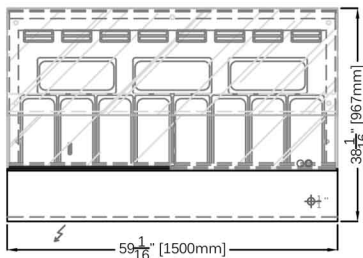
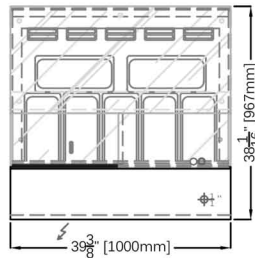

REAR ELEVATIONS (OPERATOR SIDE):

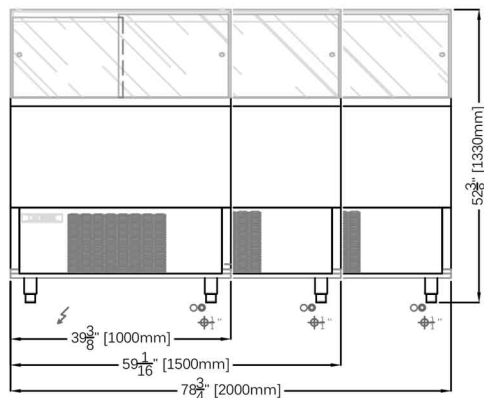

ELECTRICAL LEGEND

	REFRIGERATED LINES
	DRAIN
	POWER

* Manufacturer reserves the right to change specifications without notice. Not responsible for error and omissions.



361-367 Beach Road, Burlingame, CA 94010
 Tel: 855.885.2400 | 650.342.2400 | Fax: 650.342.7400
 sales@oscartek.com | www.oscartek.com

