

# CLASSIC SQUARE

## Hot Showcase

### STANDARD FEATURES

- Stainless steel insulated body with tubular painted galvanized chassis
- Tilt back front glass
- LED lighting
- Plexiglass sliding doors
- Stainless steel work bench
- CS: dry warm top on stainless steel basin
- CBM: hot well food warmer. Each well has its own individual control to regulate the temperature
- Cases ship standard unfinished front and stainless steel skin sides

### OPTIONS

- Stainless steel insert
- Marble/Granite work counter
- RAL color finish/wood laminate
- Roll down curtain
- Matching front cabinetry counters with top glass
- Heated glass shelf with electronic control
- Casters



CLASSIC SQUARE HOT (CS - DRY)				
TECHNICAL FEATURES		MODELS		
		CLASSIC SCS1000	CLASSIC SCS1500	CLASSIC SCS2000
External Dimensions (L-D-H)	Inches	*39 3/8" - 38 1/16" - 52 3/8"	*59 1/8" - 38 1/16" - 52 3/8"	*78 3/4" - 38 1/16" - 52 3/8"
	Inches-MM	*1000 - 967 - 1330	*1500 - 967 - 1330	*2000 - 967 - 1330
Crated Dimensions (L-D-H)	Inches	44" - 44" - 58"	65" - 44" - 58"	84 3/4" - 44" - 58"
	Inches-MM	1100 - 1100 - 1473	1600 - 1100 - 1473	2100 - 1100 - 1473
Heat Lamp **	(V/A)	220V/3A	220V/4A	220V/5 A
Power Supply	(V)	220V	220V	220V
Ameperage	(A)	12A	14A	16A
Power Consumption	(W)	1550W	2070W	3080W
Operating Temperature	°C / °F	80°C / 177°F	80°C / 177°F	80°C / 177°F
Net Weights	Kg/Lb	155Kgs / 241Lbs	206Kgs / 453Lbs	257Kgs / 565Lbs
Crated Weights	Kg/Lb	170Kgs / 374Lbs	226Kgs / 497Lbs	283Kgs / 622Lbs

\* DIMENSIONS ARE WITHOUT SIDE PANELS      NOTES: 1) \*\* REQUIRES SEPERATE POWER SUPPLY  
2) NEMA 6-15P PLUG

CLASSIC SQUARE HOT (CBM - BAIN MARIE)				
TECHNICAL FEATURES		MODELS		
		CLASSIC SCBM1000	CLASSIC SCBM1500	CLASSIC SCBM2000
External Dimensions (L-D-H)	Inches	*39 3/8" - 38 1/16" - 52 3/8"	*59 1/8" - 38 1/16" - 52 3/8"	*78 3/4" - 38 1/16" - 52 3/8"
	Inches-MM	*1000 - 967 - 1330	*1500 - 967 - 1330	*2000 - 967 - 1330
Crated Dimensions (L-D-H)	Inches	44" - 44" - 58"	65" - 44" - 58"	84 3/4" - 44" - 58"
	Inches-MM	1100 - 1100 - 1473	1600 - 1100 - 1473	2100 - 1100 - 1473
Number of Wells (CBM) **	#	2	4	5
Power Supply ***	(V/A)	208-220V / 12A	208-220V / 23A	208-220V / 29A
Power Consumption	(W)	2400W	4850W	6020W
Drain	--	3/4" Drain / 1" Manifold	3/4" Drain / 1" Manifold	3/4" Drain / 1" Manifold
Water Supply ****	--	1/4"	1/4"	1/4"
Net Weights	Kg/Lb	155Kgs / 241Lbs	206Kgs / 453Lbs	257Kgs / 565Lbs
Crated Weights	Kg/Lb	170Kgs / 374Lbs	226Kgs / 497Lbs	283Kgs / 622Lbs

\* DIMENSIONS ARE WITHOUT SIDE PANELS      NOTES: 1) \*\* FLOOR SINK IS REQUIRED FOR WET APPLICATION  
2) \*\*\* AVAILABLE IN 3 PHASE CONFIGURATION  
3) \*\*\*\* AUTO FILL OPTION

\* Manufacturer reserves the right to change specifications without notice. Not responsible for error and omissions.



361-367 Beach Road, Burlingame, CA 94010  
Tel: 855.885.2400 | 650.342.2400 | Fax: 650.342.7400  
sales@oscartek.com | www.oscartek.com



# CLASSIC SQUARE

## Hot Showcase

### STANDARD - CS-DRY

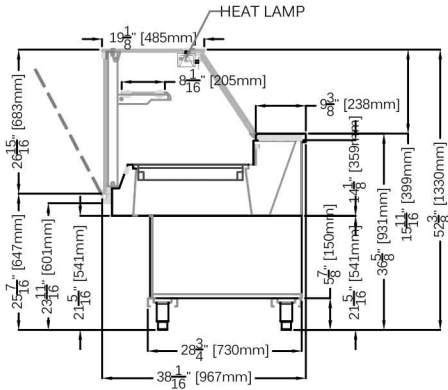

### STANDARD - CBM-BAIN MAIRE

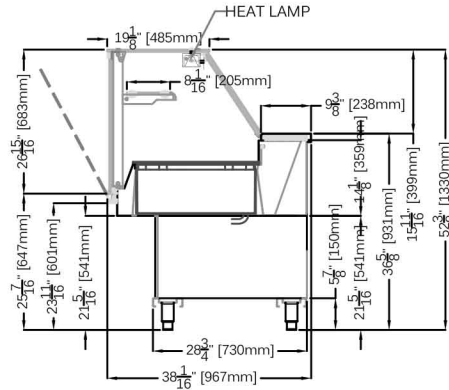

### OPTIONAL: 45 1/4" H

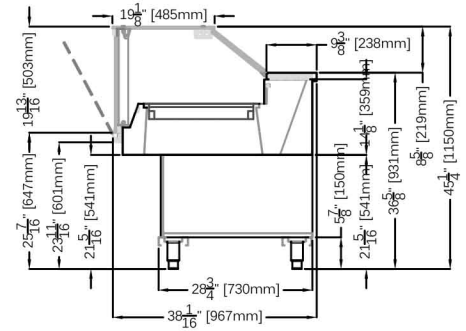

### PLAN VIEWS - CS-DRY:

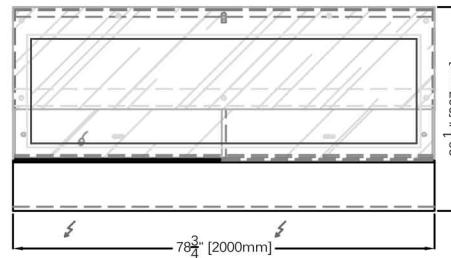
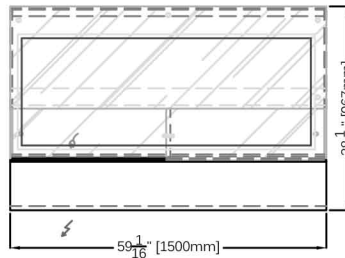
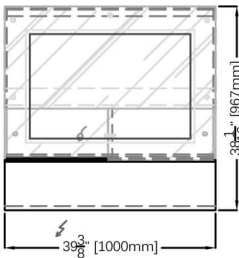

### PLAN VIEWS - CBM-BAIN MAIRE:

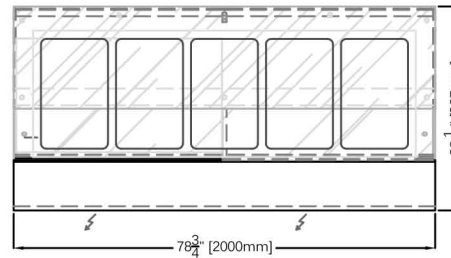
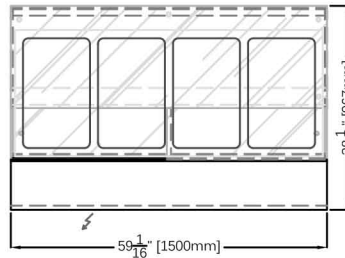
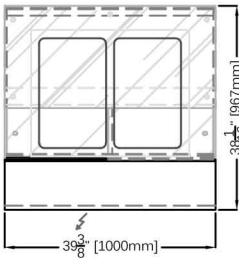

### REAR ELEVATIONS (OPERATOR SIDE) CS-DRY

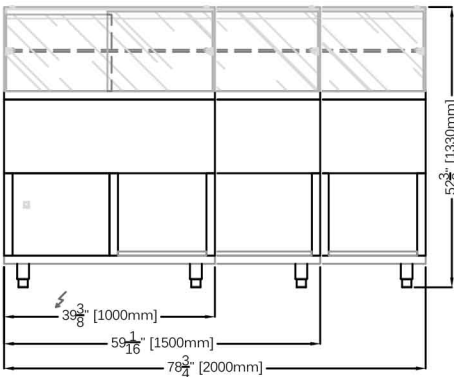

### REAR ELEVATIONS (OPERATOR SIDE) CBM-BAIN MAIRE

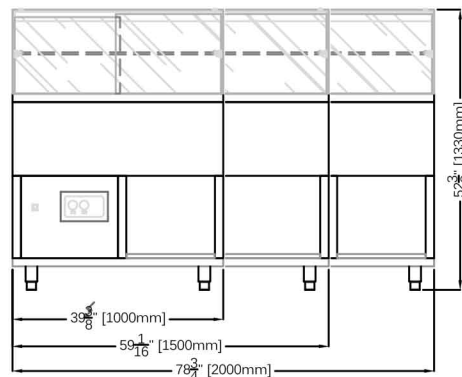

#### ELECTRICAL LEGEND

	REFRIGERATED LINES
	DRAIN
	POWER

\* Manufacturer reserves the right to change specifications without notice. Not responsible for error and omissions.



361-367 Beach Road, Burlingame, CA 94010  
 Tel: 855.885.2400 | 650.342.2400 | Fax: 650.342.7400  
 sales@oscartek.com | www.oscartek.com

