

ROSA RED MEAT SHOWCASE

STANDARD FEATURES

- Extra clear glass: front and top glasses with front air baffle
- Heated glass sides
- Diffused LED lighting 3000°K
- Sliding acrylic back doors
- Stainless steel lower interior foam tub
- Galvanized chassis structure
- All tempered glass
- Cases ship standard unfinished front and stainless steel skin sides



Photo shown with front and side finish by others. Standard cases are unfinished front with stainless steel skin sides.

OPTIONS

- Available in 53 1/8”H with non-refrigerated shelf
- Narrow depth 25 7/16”D
- Lift up top glass
- Lift up mechanism for display plate and evaporator (linear models only)
- Work top perimeter (brushed s/s, corian, black HPL, granite)
- Stainless steel step shelf
- Remote condensing unit
- RAL color finish/wood laminate front and side panels
- Epoxy RAL color interior over stainless steel
- Unfinished panels to accept custom millwork by others
- Heated pan for evaporator
- Casters



Visit our website for more finishing options and RAL colors
www.oscartek.com

| ROSA RED MEAT | | | | | | |
|--------------------------------|-----------------|--------------------------------|-------------------------------|--------------------------------|--------------------------------|--------------------------------|
| TECHNICAL FEATURES | | MODELS | | | | |
| | | ROSA RM900 | ROSA RM1000 (ROSAMR43912) | ROSA RM1300 | ROSA RM1500 (ROSAMR45912) | ROSA RM1700 |
| External Dimensions (L-D-H) | Inches | *35 9/16" - 32 5/16" - 47 1/4" | *39 1/2" - 32 5/16" - 47 1/4" | *51 5/16" - 32 5/16" - 47 1/4" | *59 3/16" - 32 5/16" - 47 1/4" | *67 1/16" - 32 5/16" - 47 1/4" |
| Inches-MM | MM | *903 - 821 - 1200 | *1003 - 821 - 1200 | *1303 - 821 - 1200 | *1503 - 821 - 1200 | *1703 - 821 - 1200 |
| Crated Dimensions (L-D-H) | Inches | 43 1/3" - 40 1/2" - 55 1/4" | 46" - 40 1/2" - 55 1/4" | 58" - 40 1/2" - 55 1/4" | 66" - 40 1/2" - 55 1/4" | 73" - 40 1/2" - 55 1/4" |
| Inches-MM | MM | 1100 - 1030 - 1400 | 1168 - 1030 - 1400 | 1473 - 1030 - 1400 | 1676 - 1030 - 1400 | 1854 - 1030 - 1400 |
| Refrigeration | Type | Fan Ventilated | Fan Ventilated | Fan Ventilated | Fan Ventilated | Fan Ventilated |
| Refrigeration Display Area | Type | Deck | Deck | Deck | Deck | Deck |
| Operating Temperature | °F | 39°F | 39°F | 39°F | 39°F | 39°F |
| Compressor | Nr./Type | 1 / Hermetic | 1 / Hermetic | 1 / Hermetic | 1 / Hermetic | 1 / Hermetic |
| BTU'S @ +14°F Evap Temperature | BTU's | 2000 | 2100 | 2700 | 3200 | 3400 |
| Electric Supply | (V/Ph/Hz) | 115/1/60 | 115/1/60 | 115/1/60 | 115/1/60 | 115/1/60 |
| Power Consumption | (W/A) | 700/7.0 | 750/7.1 | 850/8.1 | 1150/10.9 | 1200/11.0 |
| Defrost | Mode/Type | Automatic | Automatic | Automatic | Automatic | Automatic |
| Climatic Class | °F/H.R. | 75°F-55%RH | 75°F-55%RH | 75°F-55%RH | 75°F-55%RH | 75°F-55%RH |
| Refrigerant Gas | Type | R404A / R452A | R404A / R452A | R404A / R452A | R404A / R452A | R404A / R452A |
| Pipe Size (Inches) | Suction, Liquid | 3/8" Suction, 1/4" Liquid | 3/8" Suction, 1/4" Liquid | 3/8" Suction, 1/4" Liquid | 1/2" Suction, 1/4" Liquid | 3/8" Suction, 1/4" Liquid |
| Net Weights | Lb | 240 | 260 | 279 | 320 | 350 |
| Crated Weights | Lb | 350 | 370 | 410 | 466 | 512 |

*DIMENSIONS WITH POLISHED S/S SKIN SIDES

*Factory in its effort to upgrade and improve our products, has the right to change, modify, discontinue or change any feature, size or capacity on any model without prior notice.



512 South Airport Blvd., South San Francisco, CA 94080
Tel: 855.885.2400 | 650.342.2400 | Fax: 650.342.7400
sales@oscartek.com | www.oscartek.com



ROSA RED MEAT SHOWCASE

| ROSA RED MEAT | | | | | |
|--------------------------------|-----------------|-------------------------------|---------------------------------|--------------------------------|--------------------------------|
| TECHNICAL FEATURES | | MODELS | | | |
| | | ROSA RM2000 (ROSAMR47912) | ROSA RM2100 | ROSA RM2600 (ROSAMR410212) | ROSA RM3000 (ROSAMR411812) |
| External Dimensions (L-D-H) | Inches | *78 7/8" - 32 5/16" - 47 1/4" | *82 13/16" - 32 5/16" - 47 1/4" | *102 1/2" - 32 5/16" - 47 1/4" | *118 1/4" - 32 5/16" - 47 1/4" |
| Inches-MM | MM | *2003 - 821 - 1200 | *2103 - 821 - 1200 | *2603 - 821 - 1200 | *3003 - 821 - 1200 |
| Crated Dimensions (L-D-H) | Inches | 85" - 40 1/2" - 55 1/4" | 90 1/2" - 40 1/2" - 55 1/4" | 109" - 40 1/2" - 55 1/4" | 125" - 40 1/2" - 55 1/4" |
| Inches-MM | MM | 2159 - 1030 - 1400 | 2300 - 1030 - 1400 | 2768 - 1030 - 1400 | 3175 - 1030 - 1400 |
| Refrigeration | Type | Fan Ventilated | Fan Ventilated | Fan Ventilated | Fan Ventilated |
| Refrigeration Display Area | Type | Deck | Deck | Deck | Deck |
| Operating Temperature | °F | 39°F | 39°F | 39°F | 39°F |
| Compressor | Nr./Type | 1 / Hermetic | 1 / Hermetic | 1 / Hermetic | 1 / Hermetic |
| BTU'S @ +14°F Evap Temperature | BTU's | 4000 | 4400 | 4800 | 5500 |
| Electric Supply | (V/Ph/Hz) | 115/1/60 | 115/1/60 | 115/1/60 | 115/1/60 |
| Power Consumption | (W/A) | 1350/12.9 | 1400/13.0 | 1500/14.2 | 1750/17.5 |
| Defrost | Mode/Type | Automatic | Automatic | Automatic | Automatic |
| Climatic Class | °F/H.R. | 75°F-55%RH | 75°F-55%RH | 75°F-55%RH | 75°F-55%RH |
| Refrigerant Gas | Type | R404A / R452A | R404A / R452A | R404A / R452A | R404A / R452A |
| Pipe Size (Inches) | Suction, Liquid | 5/8" Suction, 5/16" Liquid | 5/8" Suction, 5/16" Liquid | 5/8" Suction, 5/16" Liquid | 5/8" Suction, 5/16" Liquid |
| Net Weights | Lb | 380 | 420 | 459 | 550 |
| Crated Weights | Lb | 540 | 610 | 650 | 730 |

*DIMENSIONS WITH POLISHED S/S SKIN SIDES

| ROSA RED MEAT | | | |
|--------------------------------|-----------------|---------------------------------|-------------------------------|
| TECHNICAL FEATURES | | MODELS | |
| | | ROSA RMA90SQ (ROSAMR4AP9012) | ROSA RMA90C |
| External Dimensions (L-D-H) | Inches | *51 1/4" - 32 5/16" - 47 1/4" | *78 1/8" - 32 5/16" - 47 1/4" |
| Inches-MM | MM | *1302 - 821 - 1200 | *1984 - 821 - 1200 |
| Crated Dimensions (L-D-H) | Inches | 57" - 57" - 55 1/4" | 87" - 40 1/2" - 55 1/4" |
| Inches-MM | MM | 1447 - 1447 - 1400 | 2209 - 1030 - 1400 |
| Refrigeration | Type | Fan Ventilated | Fan Ventilated |
| Refrigeration Display Area | Type | Deck | Deck |
| Operating Temperature | °F | 39°F | 39°F |
| Compressor | Nr./Type | 1 / Hermetic | 1 / Hermetic |
| BTU'S @ +14°F Evap Temperature | BTU's | 4800 | 5400 |
| Electric Supply | (V/Ph/Hz) | 115/1/60 | 115/1/60 |
| Power Consumption | (W/A) | 1500/14.2 | 1500/14.2 |
| Defrost | Mode/Type | Automatic | Automatic |
| Climatic Class | °F/H.R. | 75°F-55%RH | 75°F-55%RH |
| Refrigerant Gas | Type | R404A / R452A | R404A / R452A |
| Pipe Size (Inches) | Suction, Liquid | 5/8" Suction, 5/16" Liquid | 5/8" Suction, 5/16" Liquid |
| Net Weights | Lb | 380 | 380 |
| Crated Weights | Lb | 540 | 540 |

*DIMENSIONS WITH POLISHED S/S SKIN SIDES

*Factory in its effort to upgrade and improve our products, has the right to change, modify, discontinue or change any feature, size or capacity on any model without prior notice.

ROSA RED MEAT SHOWCASE

SECTION VIEWS: ROSA RM900, RM1000, RM1300, RM1500, RM2000, RM2100, RM2600, RM3000, RMA90SQ, RMA90C

ALL ROSA RED MEAT
LINEAR MODELS + RMA90SQ
(EXCEPT FOR ROSA RM3000)

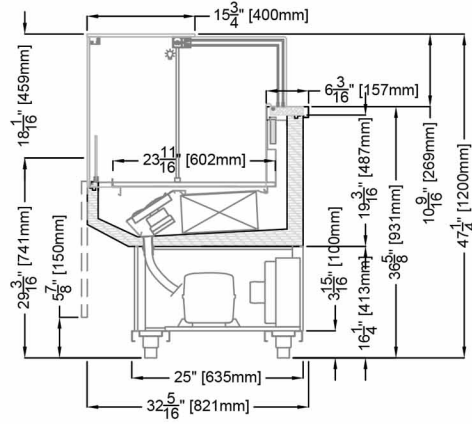

ROSA RM3000

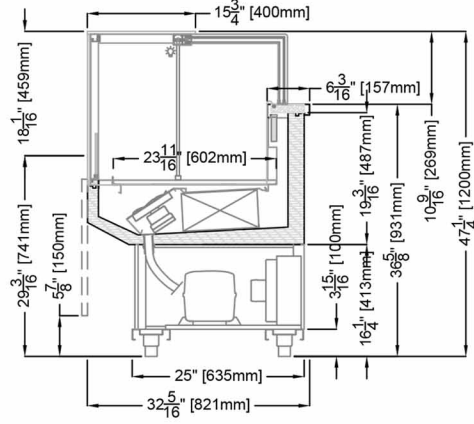

ROSA RMA90C

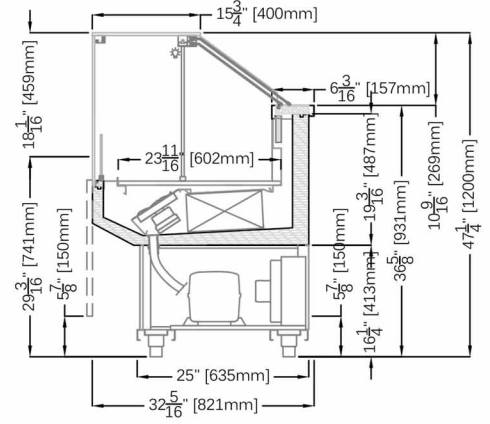

OPTIONAL:

**ROSA RED MEAT -
AVAILABLE IN 53 1/8"H WITH NON-REFRIGERATED SHELF**

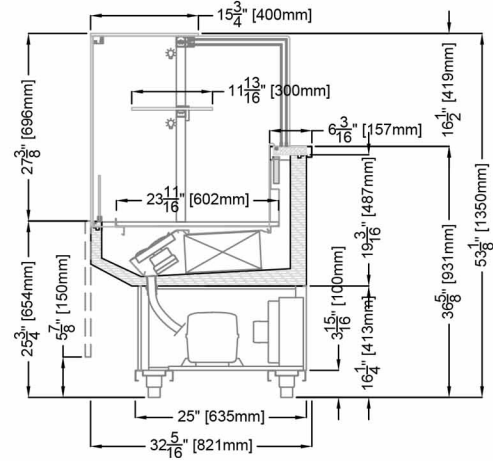

**Factory in its effort to upgrade and improve our products, has the right to change, modify, discontinue or change any feature, size or capacity on any model without prior notice.*



512 South Airport Blvd., South San Francisco, CA 94080
Tel: 855.885.2400 | 650.342.2400 | Fax: 650.342.7400
sales@oscartek.com | www.oscartek.com



ROSA RED MEAT SHOWCASE

PLAN VIEWS: ROSA RM900, RM1000, RM1300, RM1500, RM1700, RM2000, RM2100, RM2600, RM3000, RMA90SQ, RMA90C

ROSA RED MEAT LINEAR MODELS

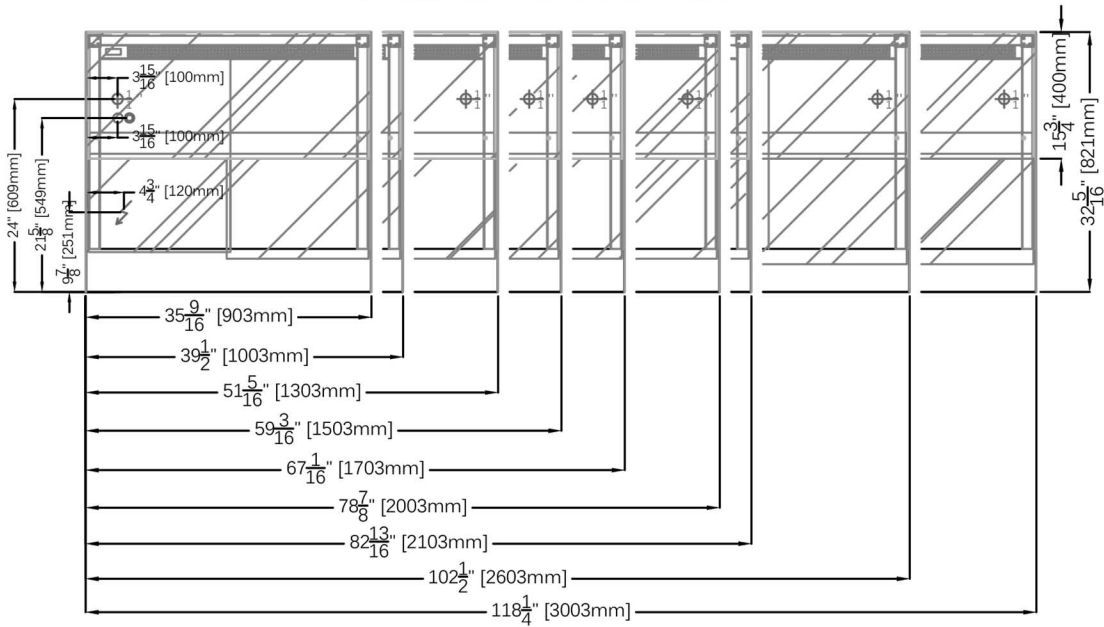

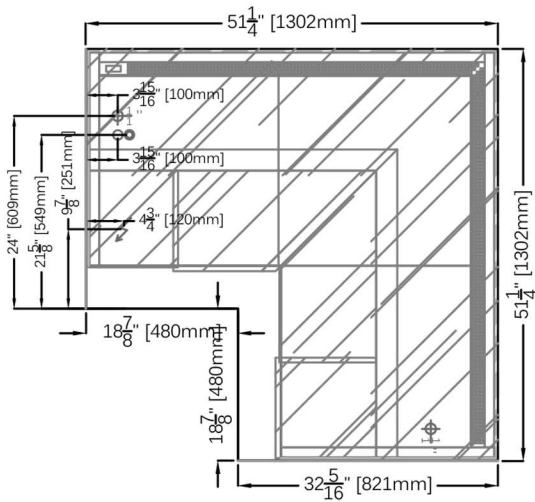

ROSA RMA90SQ

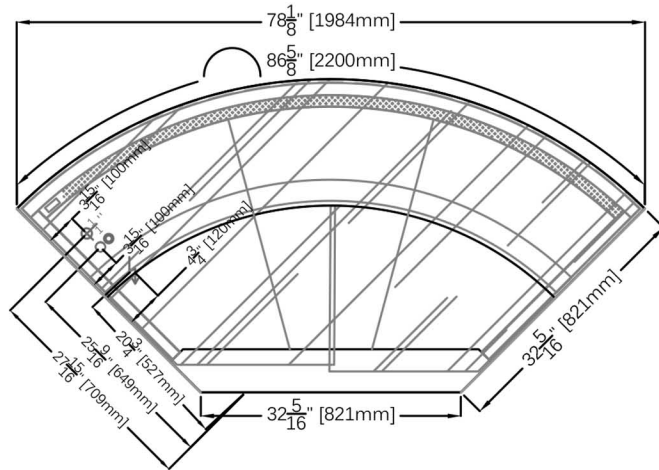

ROSA RMA90C



| ELECTRICAL LEGEND | |
|---|--------------------|
|  | REFRIGERATED LINES |
|  | DRAIN |
|  | POWER |

**Factory in its effort to upgrade and improve our products, has the right to change, modify, discontinue or change any feature, size or capacity on any model without prior notice.*

ROSA RED MEAT SHOWCASE

REAR ELEVATIONS (OPERATOR SIDE): SHOWN WITH OPTIONAL REAR VENTILATION ON LINEAR MODELS
ROSA RM900, RM1000, RM1300, RM1500, RM1700, RM2000, RM2100, RM2600, RM3000, RMA90SQ, RMA90C

ROSA RED MEAT LINEAR MODELS

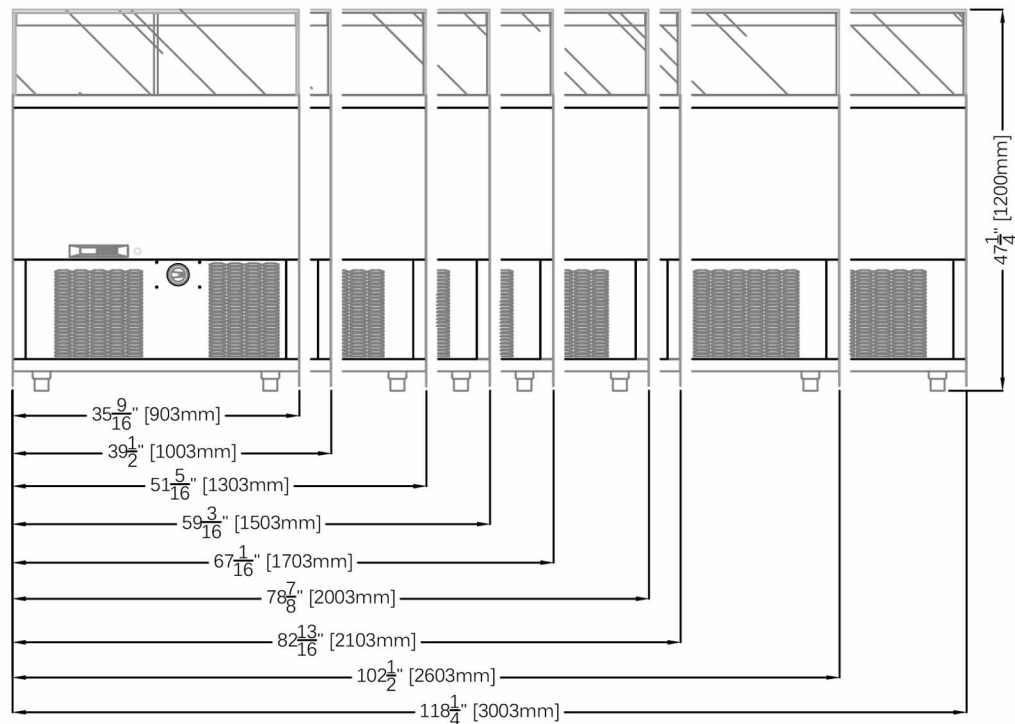

ROSA RMA90SQ

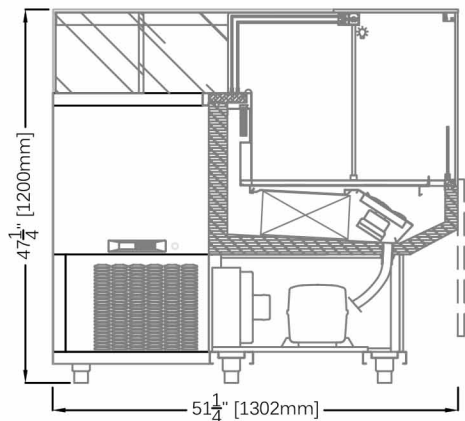

ROSA RMA90C

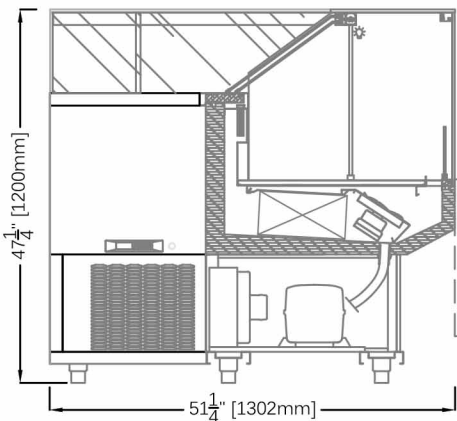

**Factory in its effort to upgrade and improve our products, has the right to change, modify, discontinue or change any feature, size or capacity on any model without prior notice.*



512 South Airport Blvd., South San Francisco, CA 94080
Tel: 855.885.2400 | 650.342.2400 | Fax: 650.342.7400
sales@oscartek.com | www.oscartek.com

