

CLASSIC SQUARE

Neutral Showcase

STANDARD FEATURES

- Stainless steel insulated body with tubular painted galvanized chassis
- Tilt back front glass
- LED lighting
- Plexiglass sliding doors
- Stainless steel work bench
- Cases ship standard unfinished front and stainless steel skin sides

OPTIONS

- Marble/Granite work counter
- RAL color finish/wood laminate
- Roll down curtain
- Matching front cabinetry counters with top glass
- Casters



CLASSIC SQUARE NEUTRAL					
TECHNICAL FEATURES		MODELS			
		CLASSIC SN1000	CLASSIC SN1500	CLASSIC SN2000	CLASSIC SN2500
External Dimensions (L-D-H)	Inches	*39 3/8" - 38 1/16" - 52 3/8"	*59 1/8" - 38 1/16" - 52 3/8"	*78 3/4" - 38 1/16" - 52 3/8"	*98 7/16" - 38 1/16" - 52 3/8"
	Inches-MM	*1000 - 967 - 1330	*1500 - 967 - 1330	*2000 - 967 - 1330	*2500 - 967 - 1330
Crated Dimensions (L-D-H)	Inches	44" - 44" - 58"	65" - 44" - 58"	84 3/4" - 44" - 58"	104" - 44" - 58"
	Inches-MM	1100 - 1100 - 1473	1600 - 1100 - 1473	2100 - 1100 - 1473	2641 - 1100 - 1473
Power Supply	(V)	120V	120V	120V	120V
Amperage	(A)	3A	4A	4.5A	5A
Operating Temperature	°F	Ambient	Ambient	Ambient	Ambient
Net Weights	Kg/Lb	130Kgs / 286Lbs	170Kgs / 374Lbs	210Kgs / 462Lbs	245Kgs / 539Lbs
Crated Weights	Kg/Lb	150Kgs / 297Lbs	190Kgs / 418Lbs	230Kgs / 506Lbs	271Kgs / 596Lbs

* DIMENSIONS ARE WITHOUT SIDE PANELS

CLASSIC SQUARE NEUTRAL					
TECHNICAL FEATURES		MODELS			
		CLASSIC SN3000	CLASSIC SNA90C	CLASSIC SNA90SQ	
External Dimensions (L-D-H)	Inches	*118 1/8" - 38 1/16" - 52 3/8"	**80 3/4" - 38 1/16" - 52 3/8"	**41 3/16 - 38 1/16" - 52 3/8	
	Inches-MM	*3000 - 967 - 1330	**2051 - 967 - 1330	**1047 - 967 - 1330	
Crated Dimensions (L-D-H)	Inches	124" - 44" - 58"	86" - 44" - 58"	47" - 44 - 58"	
	Inches-MM	3149 - 1100 - 1473	2184 - 1100 - 1473	1193 - 1100 - 1473	
Power Supply	(V)	120V	120V	120V	
Amperage	(A)	5.5A	4A	4A	
Operating Temperature	°F	Ambient	Ambient	Ambient	
Net Weights	Kg/Lb	285Kgs / 627Lbs	170Kgs / 374Lbs	170Kgs / 374Lbs	
Crated Weights	Kg/Lb	310Kgs / 682Lbs	190Kgs / 418Lbs	190Kgs / 418Lbs	

* DIMENSIONS ARE WITHOUT SIDE PANELS

** PLEASE SEE PLAN VIEW FOR ADDITIONAL DIMENSIONS

* Manufacturer reserves the right to change specifications without notice. Not responsible for error and omissions.



361-367 Beach Road, Burlingame, CA 94010
 Tel: 855.885.2400 | 650.342.2400 | Fax: 650.342.7400
 sales@oscartek.com | www.oscartek.com



CLASSIC SQUARE

Neutral Showcase

STANDARD

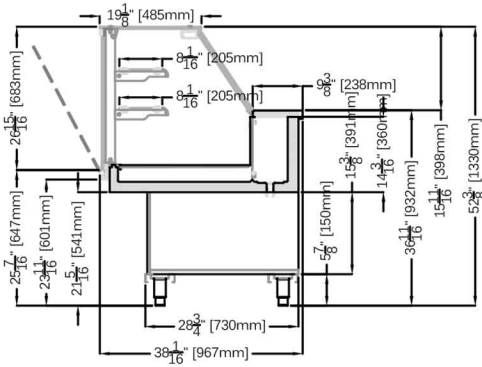

OPTIONAL: 45 1/4\"/>

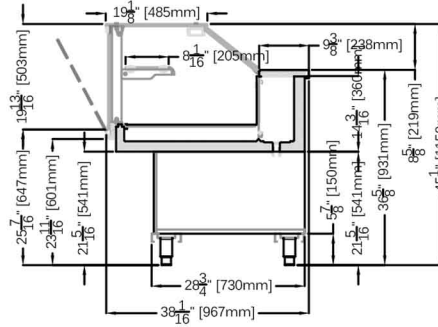

PLAN VIEWS

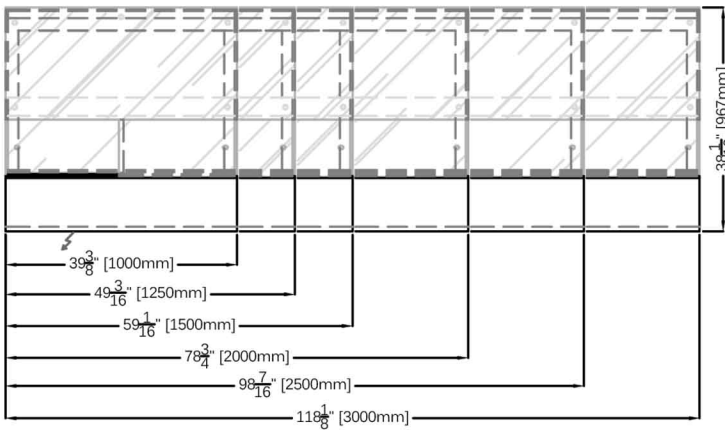

PLAN VIEW - A90 CURVE FOOTPRINT

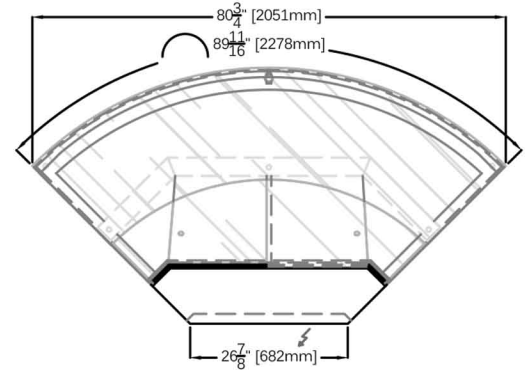

PLAN VIEWS - A90 SQUARE FOOTPRINT (LEFT & RIGHT)

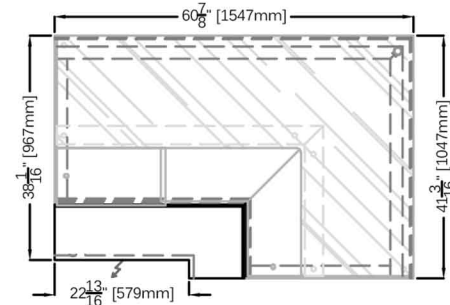
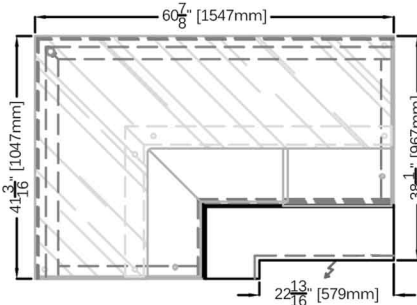

ELECTRICAL LEGEND

	REFRIGERATED LINES
	DRAIN
	POWER

* Manufacturer reserves the right to change specifications without notice. Not responsible for error and omissions.



361-367 Beach Road, Burlingame, CA 94010
 Tel: 855.885.2400 | 650.342.2400 | Fax: 650.342.7400
 sales@oscartek.com | www.oscartek.com



CLASSIC SQUARE

Neutral Showcase

REAR ELEVATIONS (OPERATOR SIDE)

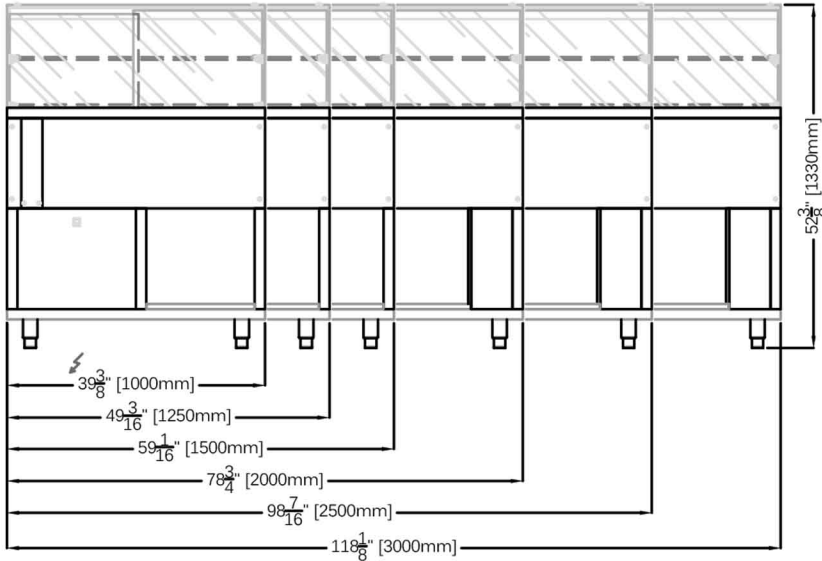

REAR ELEVATION (OPERATOR SIDE)
A90 CURVE FOOTPRINT

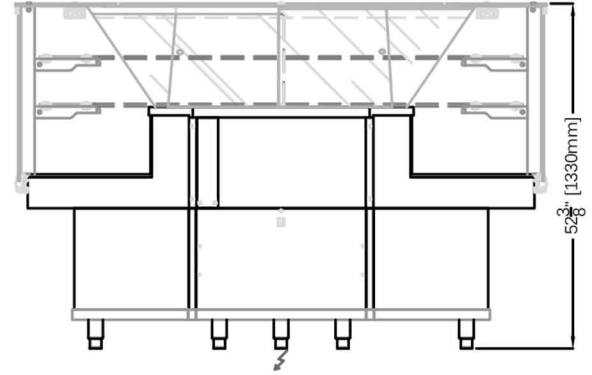

REAR ELEVATIONS (OPERATOR SIDE)
A90 SQUARE FOOTPRINT (LEFT & RIGHT)

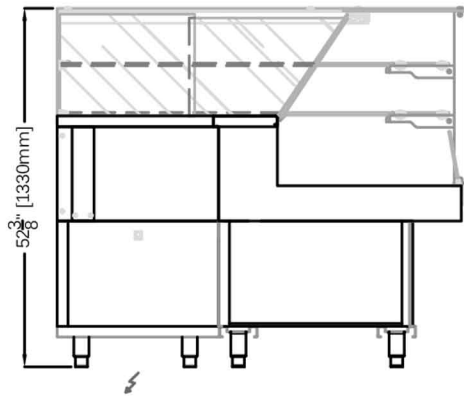
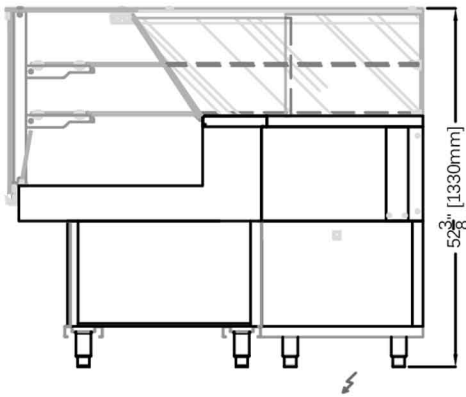

ELECTRICAL LEGEND

∞	REFRIGERATED LINES
⊕"	DRAIN
⚡	POWER

* Manufacturer reserves the right to change specifications without notice. Not responsible for error and omissions.



361-367 Beach Road, Burlingame, CA 94010
 Tel: 855.885.2400 | 650.342.2400 | Fax: 650.342.7400
 sales@oscartek.com | www.oscartek.com

