



Discover the Art of Display...

Project Name: \_\_\_\_\_  
Item #: \_\_\_\_\_ Quantity: \_\_\_\_\_

# GEM GRAB AND GO

**MODELS:** GEM GNG900, GEM GNG1000, GEM GNG1300, GEM GNG1500, GEM GNG1700, GEM GNG2000, GEM GNG2100, GEM GNG2600, GEM GNG3000, GEM GNGA90SQ, GEM GNGA90C

## STANDARD FEATURES

- Fully insulated stainless steel interior
- Galvanized chassis structure
- Case ship standard unfinished front with polished stainless steel sides

## OPTIONS

- Narrow depth – 27 ¼”D
- Cold storage
- Work top and perimeter (brushed s/s, corian, granite)
- Remote condensing unit
- RAL color/laminate front and side panels
- Unfinished panels to accept custom millwork by others
- Heated pan for evaporator
- Casters



Photo shown with optional RAL color finish. Standard cases are unfinished front and stainless steel sides.



Visit our website for more finishing options and RAL colors  
[www.oscartek.com](http://www.oscartek.com)



Photo shown with optional finish. Standard cases are unfinished front and stainless steel sides.

\*Oscartek reserves the right to change, modify, discontinue, or change any features, sizes, or capacity on any model without prior notice.

OSCARTEK®  
512 South Airport Blvd., South San Francisco, CA 94080  
Tel: 650.342.2400 | Fax: 650.342.7400  
[www.oscartek.com](http://www.oscartek.com)





Discover the Art of Display...

Project Name: \_\_\_\_\_

Item #: \_\_\_\_\_ Quantity: \_\_\_\_\_

## GEM GRAB AND GO

**MODELS:** GEM GNG900, GEM GNG1000, GEM GNG1300, GEM GNG1500, GEM GNG1700, GEM GNG2000, GEM GNG2100, GEM GNG2600, GEM GNG3000, GEM GNGA90SQ, GEM GNGA90C

### PLAN VIEWS

**GEM GRAB AND GO LINEAR MODELS**

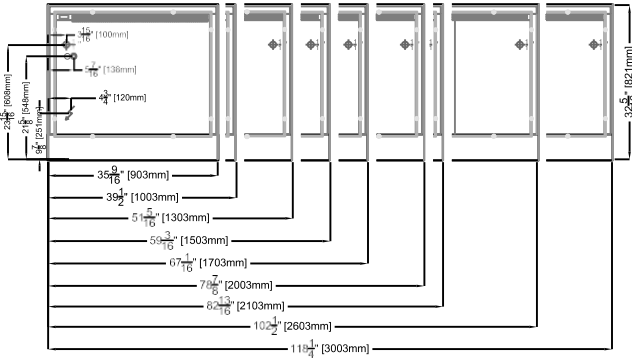

**GEM GNGA90SQ**

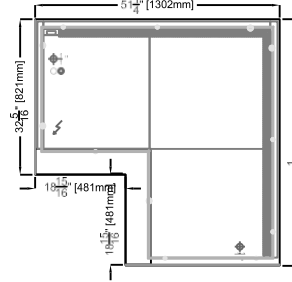

**GEM GNGA90C**

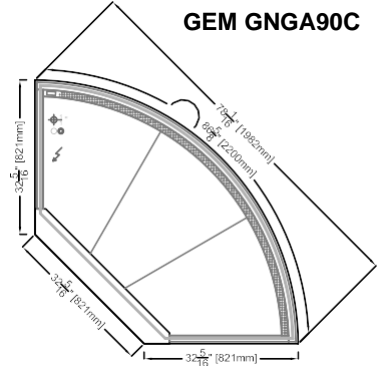

### REAR ELEVATIONS (OPERATOR SIDE)

**GEM GRAB AND GO LINEAR MODELS**

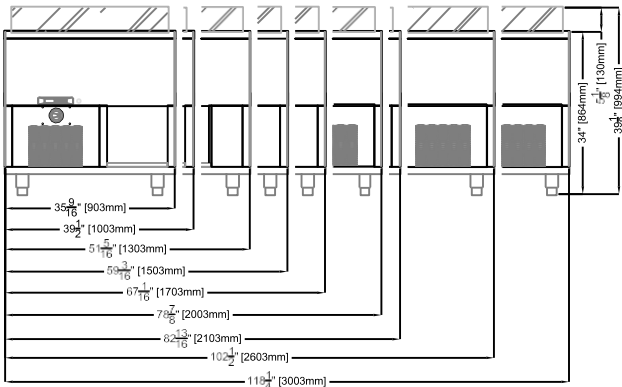

**GEM GNGA90SQ**

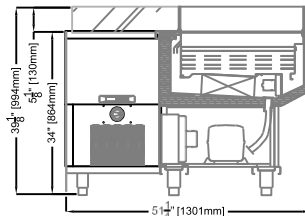

**GEM GNGA90C**

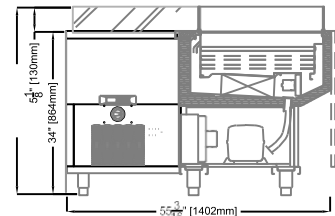

#### ELECTRICAL LEGEND

∞	REFRIGERATION LINES
⊕ 1"	DRAIN
⚡	POWER

\*Oscartek reserves the right to change, modify, discontinue, or change any features, sizes, or capacity on any model without prior notice.

OSCARTEK®  
512 South Airport Blvd., South San Francisco, CA 94080  
Tel: 650.342.2400 | Fax: 650.342.7400  
www.oscartek.com





Discover the Art of Display...

Project Name: \_\_\_\_\_

Item #: \_\_\_\_\_ Quantity: \_\_\_\_\_

# GEM GRAB AND GO

MODELS: GEM GNG900, GEM GNG1000, GEM GNG1300, GEM GNG1500, GEM GNG1700, GEM GNG2000, GEM GNG2100, GEM GNG2600, GEM GNG3000, GEM GNGA90SQ, GEM GNGA90C

## SECTION VIEWS

### STANDARD

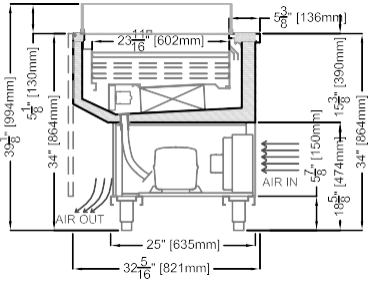

### OPTIONAL

#### GEM NARROW

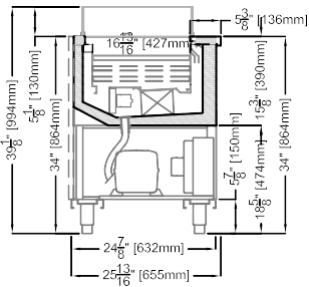

#### GEM PRO

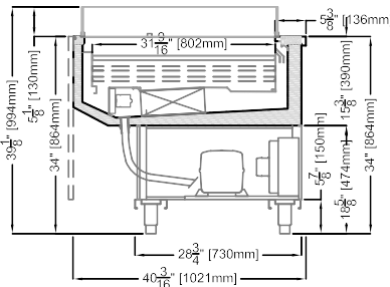

\*Oscartek reserves the right to change, modify, discontinue, or change any features, sizes, or capacity on any model without prior notice.

OSCARTEK®  
512 South Airport Blvd., South San Francisco, CA 94080  
Tel: 650.342.2400 | Fax: 650.342.7400  
www.oscartek.com





Project Name: \_\_\_\_\_  
 Item #: \_\_\_\_\_ Quantity: \_\_\_\_\_

## GEM GRAB AND GO

MODELS: GEM GNG900, GEM GNG1000, GEM GNG1300, GEM GNG1500, GEM GNG1700, GEM GNG2000, GEM GNG2100, GEM GNG2600, GEM GNG3000, GEM GNGA90SQ, GEM GNGA90C

GEM GRAB AND GO						
TECHNICAL FEATURES		MODELS				
		GEM GNG900	GEM GNG1000	GEM GNG1300	GEM GNG1500	GEM GNG1700
External Dimensions (L-D-H) Inches-MM	Inches MM	*35 9/16" - 32 5/16" - 34" *903 - 821 - 864	*39 1/2" - 32 5/16" - 34" *1003 - 821 - 864	*51 5/16" - 32 5/16" - 34" *1303 - 821 - 864	*59 3/16" - 32 5/16" - 34" *1503 - 821 - 864	*67 1/16" - 32 5/16" - 34" *1703 - 821 - 864
Crated Dimensions (L-D-H) Inches-MM	Inches MM	41" - 39 3/8" - 40" 1041 - 1000 - 1016	45" - 39 3/8" - 40" 1150 - 1000 - 1016	59" - 39 3/8" - 40" 1500 - 1000 - 1016	67" - 39 3/8" - 40" 1700 - 1000 - 1016	74 3/4" - 39 3/8" - 40" 1900 - 1000 - 1016
Refrigeration	Type	Ventilated	Ventilated	Ventilated	Ventilated	Ventilated
Refrigeration Display Area	Type	Deck	Deck	Deck	Deck	Deck
Operating Temperature	°F	40°F	40°F	40°F	40°F	40°F
Compressor	Nr./Type	1 / Hermetic	1 / Hermetic	1 / Hermetic	1 / Hermetic	1 / Hermetic
BTU'S @ +14°F Evap Temperature	BTU's	1500	1700	2200	2600	2900
Electric Supply	(V/Ph/Hz)	208-220/1/60	208-220/1/60	208-220/1/60	208-220/1/60	208-220/1/60
Power Consumption	(W/A)	550/5.2	550/5.2	650/5.9	710/6.7	850/8.1
Defrost	Mode/Type	Air	Air	Air	Air	Air
Climatic Class	°F/H.R.	75°F-55%RH	75°F-55%RH	75°F-55%RH	75°F-55%RH	75°F-55%RH
Refrigerant Gas	Type	R404A / R452A	R404A / R452A	R404A / R452A	R404A / R452A	R404A / R452A
Pipe Size (Inches)	Suction, Liquid	3/8" Suction, 1/4" Liquid	3/8" Suction, 1/4" Liquid	3/8" Suction, 1/4" Liquid	3/8" Suction, 1/4" Liquid	1/2" Suction, 1/4" Liquid
Net Weights	Lb	210	220	265	285	310
Crated Weights	Lb	378	388	415	430	438

\*DIMENSIONS ARE WITH POLISHED S/S SIDES

GEM GRAB AND GO							
TECHNICAL FEATURES		MODELS					
		GEM GNG2000	GEM GNG2100	GEM GNG2600	GEM GNG3000	GEM GNGA90SQ	GEM GNGA90C
External Dimensions (L-D-H) Inches-MM	Inches MM	*78 7/8" - 32 5/16" - 34" *2003 - 821 - 864	*82 13/16" - 32 5/16" - 34" *2103 - 821 - 864	*102 1/2" - 32 5/16" - 34" *2603 - 821 - 864	*118 1/4" - 32 5/16" - 34" *3003 - 821 - 864	*51 1/4" - 51 1/4" - 34" *1303 - 1303 - 864	*78 1/16" - 32 5/16" - 47 1/4" *1982 - 821 - 1200
Crated Dimensions (L-D-H) Inches-MM	Inches MM	84" - 39 3/8" - 40" 2150 - 1000 - 1016	89" - 39 3/8" - 40" 2260 - 1000 - 1016	109" - 39 3/8" - 40" 2768 - 1000 - 1016	125" - 39 3/8" - 40" 3175 - 1000 - 1016	58" - 58" - 40" 1397 - 1397 - 1016	87" - 40 1/2" - 55 1/4" 2209 - 1030 - 1400
Refrigeration	Type	Ventilated	Ventilated	Ventilated	Ventilated	Ventilated	Fan Ventilated
Refrigeration Display Area	Type	Deck	Deck	Deck	Deck	Deck	Deck
Operating Temperature	°F	40°F	40°F	40°F	40°F	40°F	39°F
Compressor	Nr./Type	1 / Hermetic	1 / Hermetic	1 / Hermetic	1 / Hermetic	1 / Hermetic	1 / Hermetic
BTU'S @ +14°F Evap Temperature	BTU's	3300	3700	4200	5000	3900	4200
Electric Supply	(V/Ph/Hz)	208-220/1/60	208-220/1/60	208-220/1/60	208-220/1/60	208-220/1/60	208-220/1/60
Power Consumption	(W/A)	890/8.3	1150/10.9	1250/11.7	1450/13.9	1150/10.9	1150/10.9
Defrost	Mode/Type	Air	Air	Air	Air	Air	Air
Climatic Class	°F/H.R.	75°F-55%RH	75°F-55%RH	75°F-55%RH	75°F-55%RH	75°F-55%RH	75°F-55%RH
Refrigerant Gas	Type	R404A / R452A	R404A / R452A	R404A / R452A	R404A / R452A	R404A / R452A	R404A / R452A
Pipe Size (Inches)	Suction, Liquid	1/2" Suction, 1/4" Liquid	1/2" Suction, 1/4" Liquid	5/8" Suction, 5/16" Liquid	5/8" Suction, 5/16" Liquid	1/2" Suction, 1/4" Liquid	1/2" Suction, 1/4" Liquid
Net Weights	Lb	330	350	440	490	410	350
Crated Weights	Lb	450	535	670	760	665	535

\*DIMENSIONS ARE WITH POLISHED S/S SIDES

\*Oscartek reserves the right to change, modify, discontinue, or change any features, sizes, or capacity on any model without prior notice.

OSCARTEK®  
 512 South Airport Blvd., South San Francisco, CA 94080  
 Tel: 650.342.2400 | Fax: 650.342.7400  
 www.oscartek.com

