



Discover the Art of Display...

Project Name: _____
Item #: _____ Quantity: _____



Photo shown with optional top glass with shelf - Combi and optional custom finish. Standard cases are unfinished front with polished stainless steel sides.



Visit our website for more finishing options and RAL colors
www.oscartek.com

OPTIMA PRO

Self-Serve Air Screen Refrigeration Showcase

MODELS: OPTIMA PRO 1000, OPTIMA PRO 1250, OPTIMA PRO 1500, OPTIMA PRO A90

STANDARD FEATURES

- Heated single glass sides
- Dixell digital control
- Bottom evaporator ventilation cooling
- Stainless steel foam in place bottom and top
- Adjustable feet
- Cases ship standard unfinished front with polished stainless steel sides

OPTIONS

- Top glass with shelf – Combi
- Stainless steel side panels in lieu of glass
- Black/white interior
- Remote/water cooled condensing unit
- RAL color/laminate front and side panels
- Unfinished panels to accept custom millwork by others
- Heated pan for evaporator
- Casters

*Oscartek reserves the right to change, modify, discontinue, or change any features, sizes, or capacity on any model without prior notice.

OSCARTEK®
512 South Airport Blvd., South San Francisco, CA 94080
Tel: 650.342.2400 | Fax: 650.342.7400
www.oscartek.com



OPTIMA PRO

MODELS: OPTIMA PRO 1000, OPTIMA PRO 1250, OPTIMA PRO 1500, OPTIMA PRO A90

PLAN VIEWS: STANDARD

OPTIMA PRO 1000

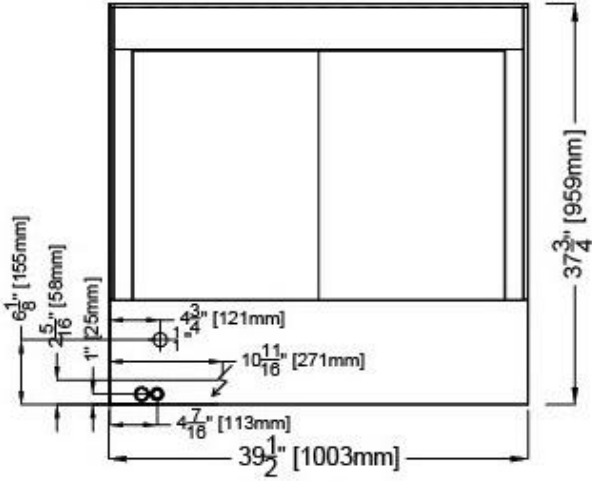

OPTIMA PRO 1250

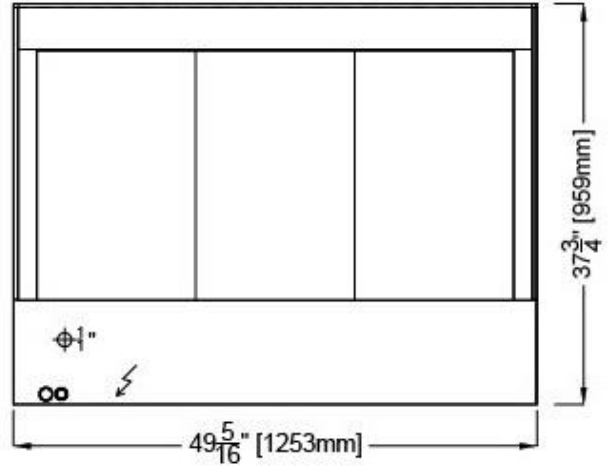

OPTIMA PRO 1500

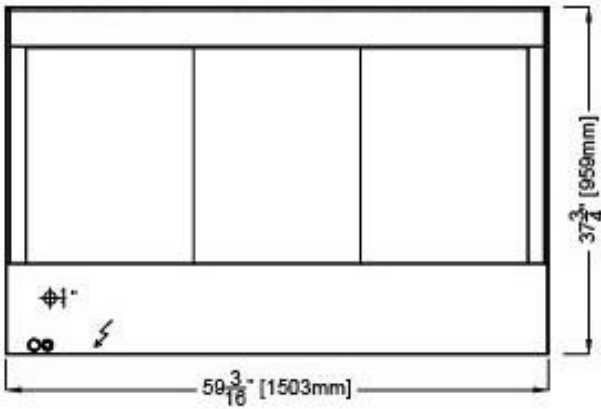

OPTIMA PRO A90

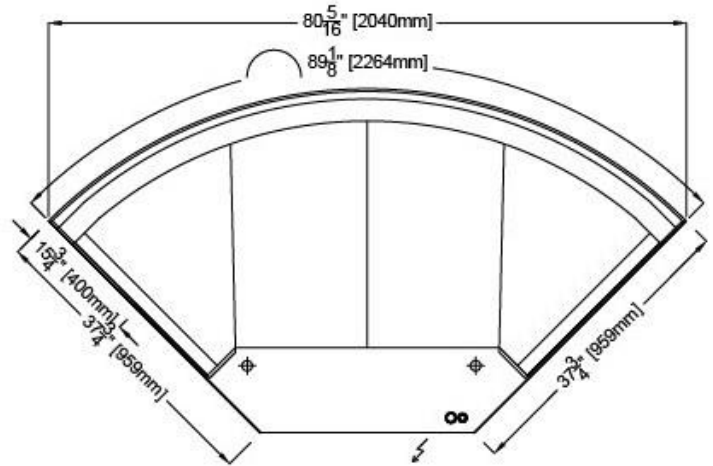

ELECTRICAL LEGEND

∞	REFRIGERATION LINES
φ 1"	DRAIN
⚡	POWER

*Oscartek reserves the right to change, modify, discontinue, or change any features, sizes, or capacity on any model without prior notice.

OSCARTEK®

512 South Airport Blvd., South San Francisco, CA 94080

Tel: 650.342.2400 | Fax: 650.342.7400

www.oscartek.com



OPTIMA PRO

MODELS: OPTIMA PRO 1000, OPTIMA PRO 1250, OPTIMA PRO 1500, OPTIMA PRO A90

REAR ELEVATIONS: STANDARD

OPTIMA PRO 1000

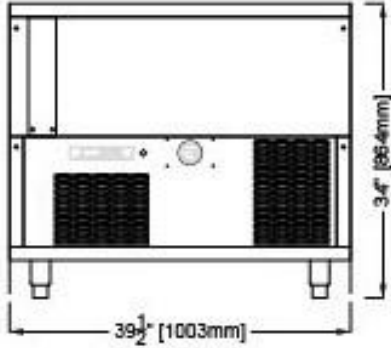

OPTIMA PRO 1250

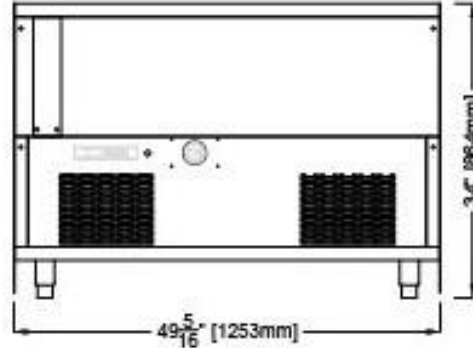

OPTIMA PRO 1500

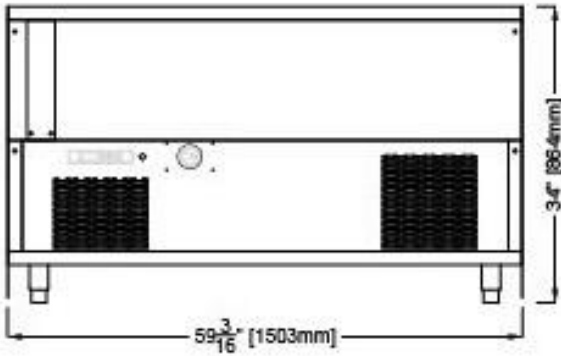

OPTIMA PRO A90

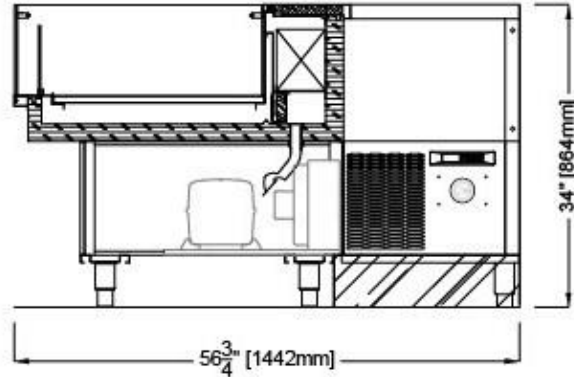

ELECTRICAL LEGEND

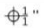
	REFRIGERATION LINES
	DRAIN
	POWER

*Oscartek reserves the right to change, modify, discontinue, or change any features, sizes, or capacity on any model without prior notice.

OPTIMA PRO – LINEAR MODELS

MODELS: OPTIMA PRO 1000, OPTIMA PRO 1250, OPTIMA PRO 1500, OPTIMA PRO A90

SECTION VIEWS: STANDARD

OPTIMA PRO - LINEAR MODELS

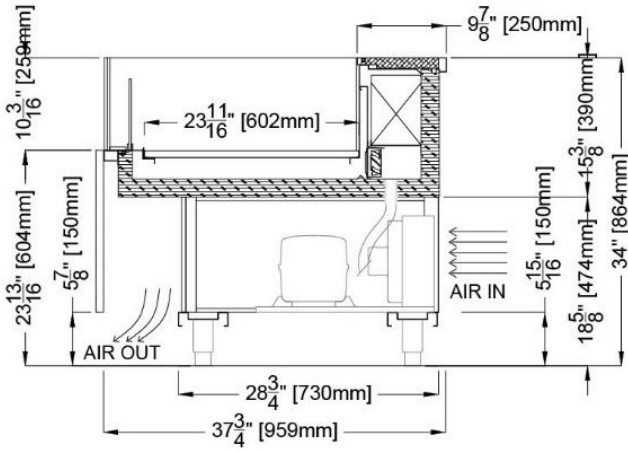

OPTIMA PRO A90

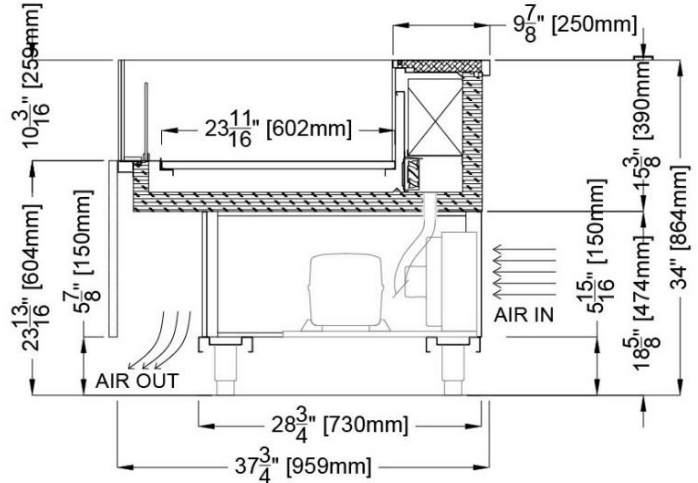

SECTION VIEWS: OPTIONALS

COMBI W/ SHELF A90 – LINEAR MODELS

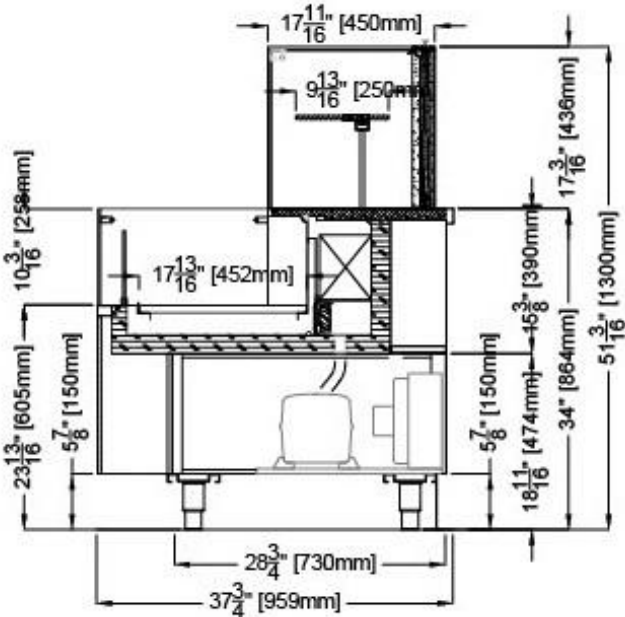

COMBI W/ SHELF A90

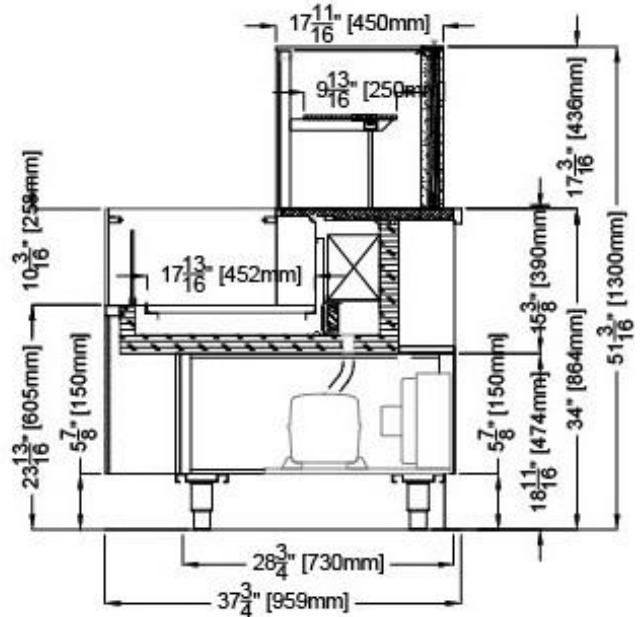

*Oscartek reserves the right to change, modify, discontinue, or change any features, sizes, or capacity on any model without prior notice.



Discover the Art of Display...

Project Name: _____

Item #: _____ Quantity: _____

OPTIMA PRO

MODELS: OPTIMA PRO 1000, OPTIMA PRO 1250, OPTIMA PRO 1500, OPTIMA PRO A90

OPTIMA PRO - SELF SERVE REFRIGERATION					
TECHNICAL FEATURES		MODELS			
		OPTIMA PRO 1000	OPTIMA PRO 1250	OPTIMA PRO 1500	OPTIMA PRO A90
External Dimensions (L-D-H) Inches-MM	Inches MM	*39 1/2" - 37 3/4" - 34" *1003 - 959 - 864	*49 5/16" - 37 3/4" - 34" *1253 - 959 - 864	*59 3/16" - 37 3/4" - 34" *1503 - 959 - 864	*80 5/16" - 37 3/4" - 34" *2040 - 959 - 864
Crated Dimensions (L-D-H) Inches-MM	Inches MM	46" - 46" - 40" 1168 - 1168 - 1016	55" - 46" - 40" 1397 - 1168 - 1016	66" - 46" - 40" 1676 - 1168 - 1016	90" - 46" - 40" 1676 - 1168 - 1016
BTU's @ +6.8°F Evap Temperature	BTU'S	2750	3750	4450	4450
Electric Supply	(V/Ph/Hz)	208-220V/60Hz	208-220V/60Hz	208-220V/60Hz	208-220V/60Hz
Power Consumption	(W/A)	1250 / 6.5	1350 / 6.9	1500 / 7.8	1500 / 7.8
Operating Temperature	°F	40°F	40°F	40°F	40°F
Climatic Class	°F/H.R.	75°F-55%RH	75°F-55%RH	75°F-55%RH	75°F-55%RH
Refrigerant Gas	Type	R404A / R452A	R404A / R452A	R404A / R452A	R404A / R452A
Pipe Size (Inches)	Suction, Liquid	3/8" Suction, 1/4" Liquid	1/2" Suction, 1/4" Liquid	3/4" Suction, 5/16" Liquid	3/4" Suction, 5/16" Liquid
Net Weights	Lb	330	380	440	440
Crated Weights	Lb	410	460	520	520
* DIMENSIONS ARE WITH POLISHED S/S SIDES					
NOTES:					
1) 85°F AMBIENT AND 55% RELATIVE HUMIDITY 2) FLOOR SINK RECOMMENDED ON THESE MODELS					

*Oscartek reserves the right to change, modify, discontinue, or change any features, sizes, or capacity on any model without prior notice.

OSCARTEK®
512 South Airport Blvd., South San Francisco, CA 94080
Tel: 650.342.2400 | Fax: 650.342.7400
www.oscartek.com

