



PROVINO I WINE - WITH STORAGE BASE



PROVINO I WINE - FULL HEIGHT

STANDARD FEATURES

Doors and Shelves: Double pane swing glass doors, (4) stainless steel wine rack supports per door (with storage base), (6) stainless steel wine rack supports per door (full height)

Lighting: 3000°K diffused LED lighting 52Px/meter with dimmer

Finish: High polish 304A stainless steel interior and exterior including door handles, base and doors

Base: Stainless steel support cabinet with carrera marble top stone shelf and condensing unit compartment housing for complete front breathing

Operating Temperature: 38°F to 58°F

Interior Ventilation: Low speed evaporator for optimal air distribution

Refrigeration: Self-contained 208-220V/1PH/14 Amps direct hard wire connection

Approvals: ETL approved for UL and NSF



OPTIONS

Finish: RAL Color Option powder coated door handles, exterior and interior over stainless

Laminate: Front wood laminate door and handles, interior shelf trim

Doors: Front wood laminate storage doors finish on base, top door and interior shelf trim. Top door and full height door locks.

Base: Cold storage base compartment

Refrigeration: Remote application, water cooled, central refrigeration rack

**Factory in its effort to upgrade and improve our products, has the right to change, modify, discontinue or change any feature, size or capacity on any model without prior notice.*



512 South Airport Blvd., South San Francisco, CA 94080
Tel: 855.885.2400 | 650.342.2400 | Fax: 650.342.7400
sales@oscartek.com | www.oscartek.com



PROVINO I WINE WITH STORAGE BASE - CB (COLD BASE) & NB (NEUTRAL BASE)				
TECHNICAL FEATURES		MODELS		
		PROVINO I W1000	PROVINO I W1500	PROVINO I W2000
External Dimensions (D-L-H)	Inches	28 1/8"D (714) Top Section 34 11/16" (Base) - 39 3/8" - 88 1/2"	28 1/8"D (714) Top Section 34 11/16" (Base) - 59 1/16" - 88 1/2"	28 1/8"D (714) Top Section 34 11/16" (Base) - 78 3/4" - 88 1/2"
Inches-MM	MM	880 - 1000 - 2248	880 - 1500 - 2248	880 - 2000 - 2248
Crated Dimensions (D-L-H)	Inches	39" - 46" - 94"	39" - 66" - 94"	39" - 85" - 94"
Inches-MM	MM	1010 - 1168 - 2388	1010 - 1676 - 2388	1010 - 2160 - 2388
Net Weights	Lb	450Lbs	650Lbs	750Lbs
Crated Weights	Kg/Lb	535Lbs	745Lbs	845Lbs
WINE CASE				
Number of Glass Doors	#	2	2	3
Diffused LED with Dimmer	°K	3000°K	3000°K	3000°K
Wine Rack Shelves	#	4	8	12
Bottle Capacity (STD size)	#	-	-	-
BTU's @ +14°F Evap Temperature	BTU's	1900 BTU'S	3100 BTU'S	4100 BTU'S
Operating Temperature	°F	38-58°F	38-58°F	38-58°F
STORAGE BASE				
Dry Storage # of doors	#	1	2	3
BTU's @ +9°F Evap Temperature	BTU's	550 BTU'S	900 BTU'S	1250 BTU'S
Operating Temperature	°F	38-58°F	38-58°F	38-58°F
Electric Supply	(V/Ph/Hz)	208-220/1/60	208-220/1/60	208-220/1/61
Power Supply				
Condensing Unit within 35Ft (10m)	(A)	6A	8A	11A
Drainage - Available with Condensate Heater	"	3/4"	3/4"	3/4"

PROVINO I WINE - FULL HEIGHT				
TECHNICAL FEATURES		MODELS		
		PROVINO I W758FH	PROVINO I W1500FH	PROVINO I W2000FH
External Dimensions (D-L-H)	Inches	29 15/16" - 29 13/16" - 79 1/8"	29 15/16" - 59 1/16" - 79 1/8"	29 15/16" - 78 3/4" - 79 1/8"
Inches-MM	MM	760 - 758 - 2010	760 - 1500 - 2010	760 - 2000 - 2010
Crated Dimensions (D-L-H)	Inches	35" - 35" - 85"	35" - 66" - 85"	35" - 85" - 85"
Inches-MM	MM	889 - 889 - 2159	889 - 1676 - 2159	889 - 2160 - 2159
Number of Glass Doors	#	1	2	3
Diffused LED with Dimmer	°K	3000°K	3000°K	3000°K
Wine Rack Shelves	#	5	10	15
Bottle Capacity (STD size)	#	-	-	-
BTU's @ +14°F Evap Temperature	BTU's	2300 BTU'S	3800 BTU'S	5200 BTU'S
Electric Supply	(V/Ph/Hz)	208-220/1/60	208-220/1/60	208-220/1/61
Power Supply				
Self Contained	(A)	5A	7A	10A
Drainage - Available with Condensate Heater	"	3/4"	3/4"	3/4"
Operating Temperature	°F	38-58°F	38-58°F	38-58°F
Net Weights	Lb	550Lbs	750Lbs	850Lbs
Crated Weights	Lb	635Lbs	845Lbs	945Lbs

*Factory in its effort to upgrade and improve our products, has the right to change, modify, discontinue or change any feature, size or capacity on any model without prior notice.



512 South Airport Blvd., South San Francisco, CA 94080
 Tel: 855.885.2400 | 650.342.2400 | Fax: 650.342.7400
 sales@oscartek.com | www.oscartek.com



PROVINO I WINE WITH STORAGE BASE

A - CB (COLD BASE)

B - NB (NEUTRAL BASE)

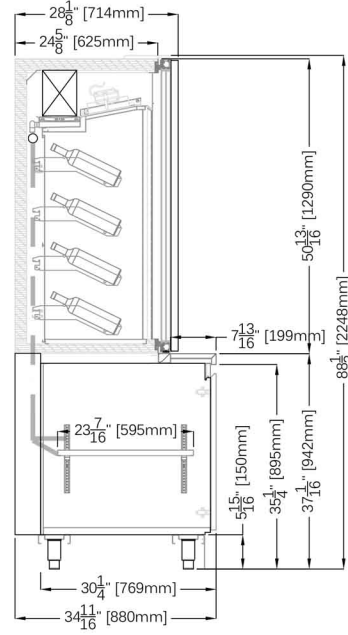
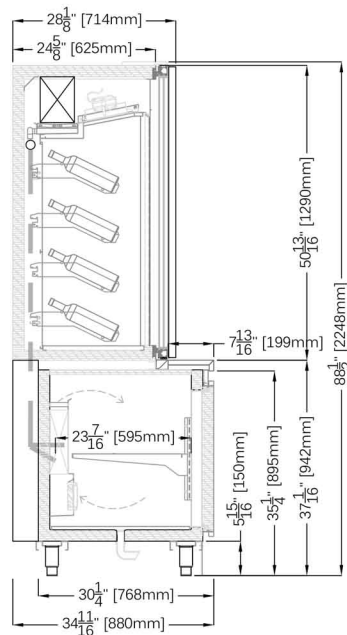

PLAN VIEWS WITH STORAGE BASE

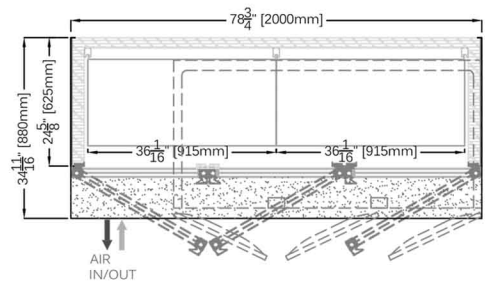
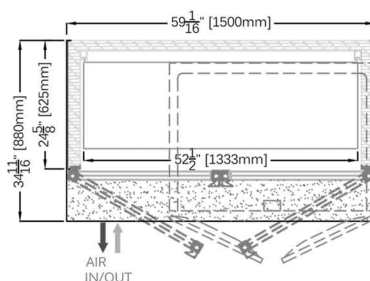
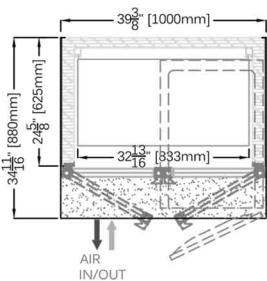

FRONT ELEVATIONS (CUSTOMER SIDE) WITH STORAGE BASE

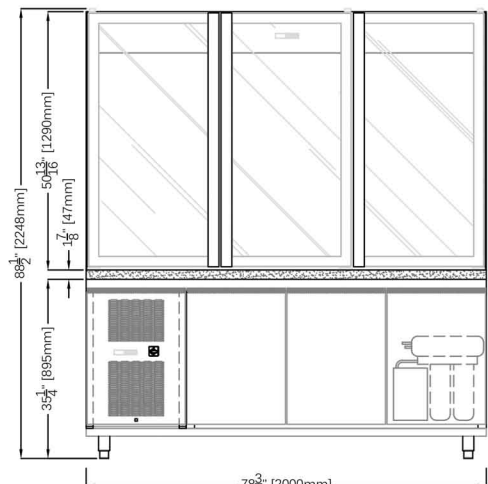
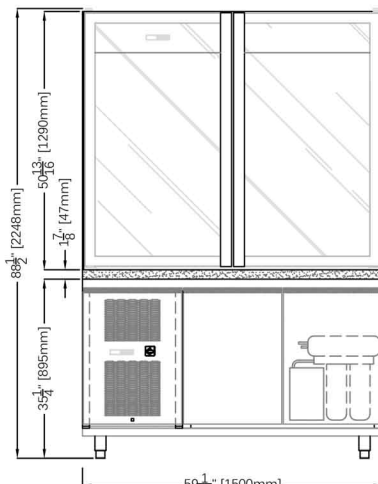
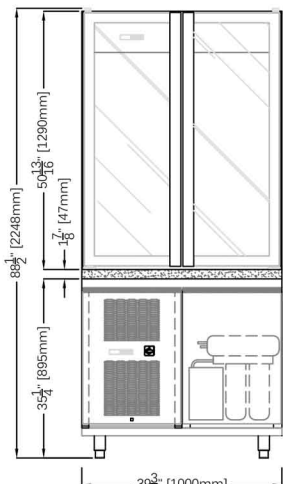

*Factory in its effort to upgrade and improve our products, has the right to change, modify, discontinue or change any feature, size or capacity on any model without prior notice.

PROVINO I WINE - FULL HEIGHT

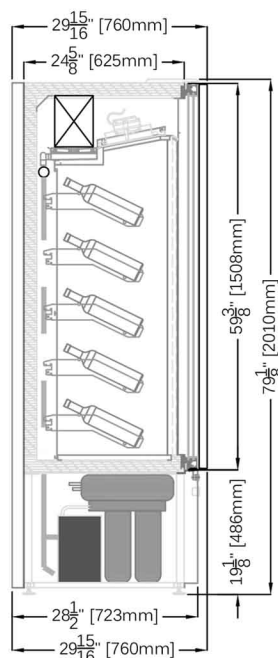

PLAN VIEWS - FULL HEIGHT

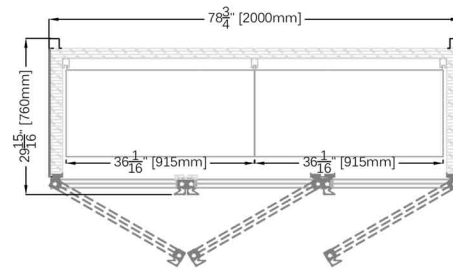
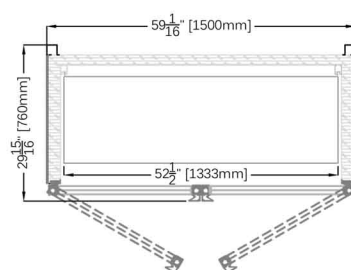
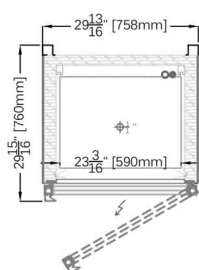

FRONT ELEVATIONS (CUSTOMER SIDE) - FULL HEIGHT

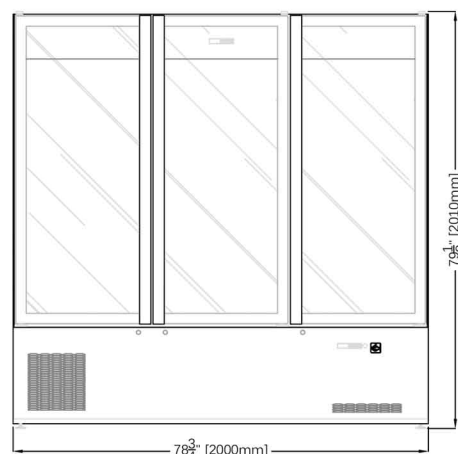
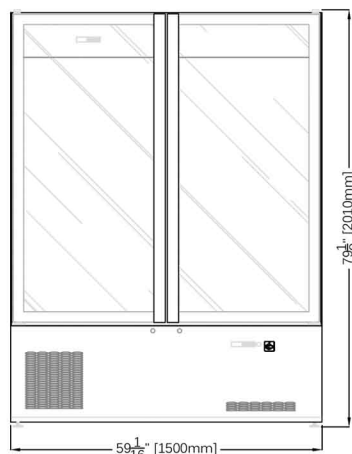
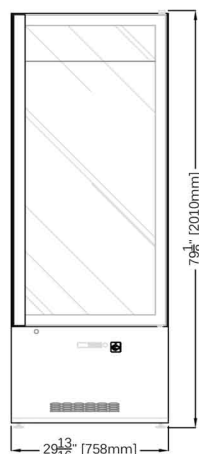

*Factory in its effort to upgrade and improve our products, has the right to change, modify, discontinue or change any feature, size or capacity on any model without prior notice.

PROVINO I WINE WITH STORAGE BASE

PROVINO I WITH
STORAGE BASE (1) DOOR

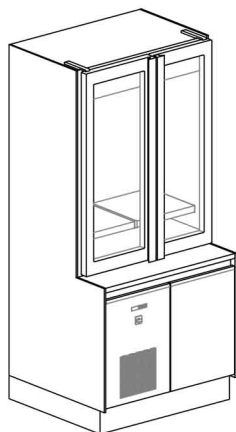

PROVINO I WITH
STORAGE BASE (2) DOORS

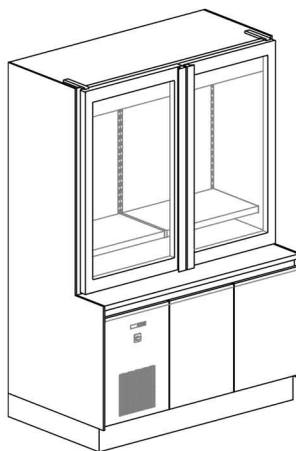

PROVINO I WITH
STORAGE BASE (3) DOORS

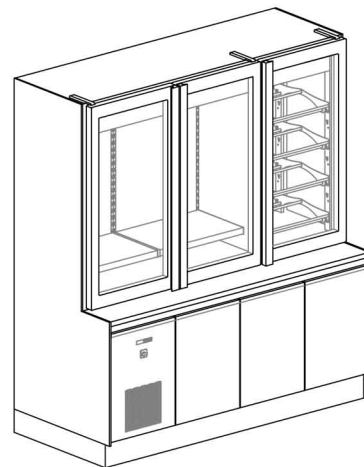

PROVINO I WINE - FULL HEIGHT

PROVINO I - FULL HEIGHT
(1) DOOR

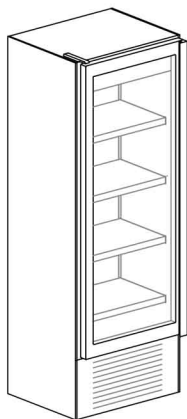

PROVINO I - FULL HEIGHT
(2) DOORS

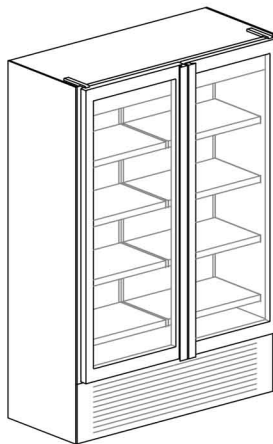

PROVINO I - FULL HEIGHT
(3) DOORS

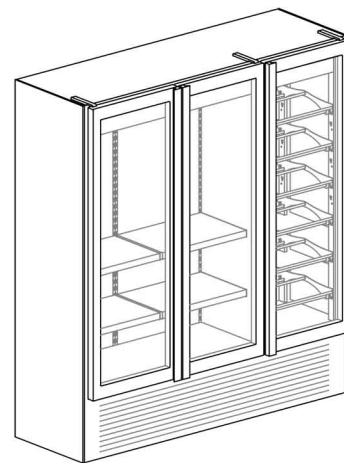

*Factory in its effort to upgrade and improve our products, has the right to change, modify, discontinue or change any feature, size or capacity on any model without prior notice.